

# REAR VIEW SYSTEM

AHD Monitor



Before using the product, please read this manual carefully and keep it for future reference.

## 1. Product specification

- 1). Screen:7 inch color TFT LCD screen
- 2). Resolution:1024\*RGB\*600
- 3). System:PAL/NTSC automatically
- 4). Support up to 4CH 1080P/720P/CVBS input
- 5). Image display: Support Single/ Double/ Triple/ Quad images display
- 6). Trigger: Support up to 4CH triggers
- 7). DC 12V~24V power supply
- 8). Operate temperature: -20 C ~+70 C
- 9). Storage temperature: -30 C ~+80 C
- 10). sun shade :Yes-removable
- 11). operation: Support panel buttons and remote control
- 12). Recording:support 4 channels real time recording
- 13). Video compression format: H.264
- 14). Video format: AVI
- 15). Automatic video recording(if insert SD card)
- 16). Storage: SD memory card(class 10), MAX 256G
- 17). Playback: support to playback of each camera



## 2. Product Introduction

### Panel introduction

- |                      |                            |
|----------------------|----------------------------|
| 1). Sunshade cap     | 7). Power                  |
| 2). Display screen   | 8). CH3                    |
| 3). Metal LOGO plate | 9). CH4                    |
| 4). MENU             | 10). Mode switch           |
| 5). CH1              | 11). Remote control window |
| 6). CH2              |                            |



### Remote control introduction

- |   |                          |
|---|--------------------------|
| 1). Startup/shutoff monitor                           | 6). CH3                  |
| 2). Return to the default screen/to the previous step | 7). CH4                  |
| 3). Switch multi-screen display mode circularly       | 8). Up                   |
| 4). CH1   | 9). Down                 |
| 5). CH2   | 10). Left                |
|   | 11). Right               |
|   | 12). Menu + confirmation |

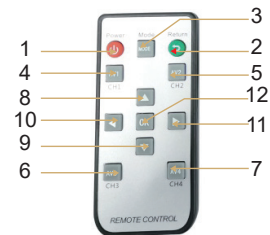

## Connection Introduction

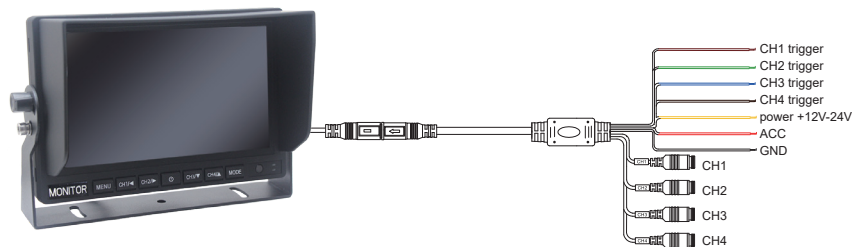

## Product Size

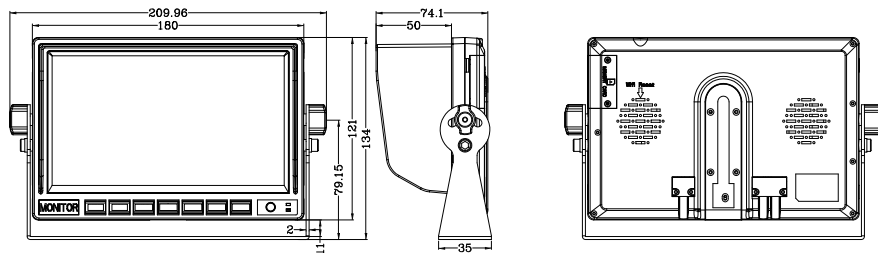

## 3. Menu Setting Introduction

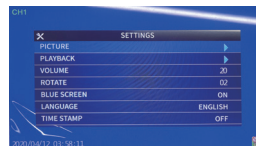

- 1). Picture settings: adjust brightness/color/contrast/reset for each camera.
- 2). Playback settings
- 3). Volume settings: adjust volume.
- 4). Rotate settings: image is flipped horizontally.
- 5). Blue screen settings: on(by default)/off(black screen).
- 6). Language settings: english(by default).
- 7). Time stamp settings: off(by default)/ on, if turn on, all channels will display the real-time and show time when played back video.
- 8). Auto cycle: off(by default)/single channel full screen display automatically.
- 9). Auto dim: off(by default)/on.
- 10). ACC delay settings: adjust delay time for each camera.
- 11). Guide line settings: on/off for each channel.
- 12). Time settings: can set the year/month/date/hour/minute/second.
- 13). Shrink video:off (by default)/on.
- 14). Mirror flip settings: off (by default)/on, mirror/non-mirror image adjustment for each channel.
- 15). Format
- 16). Reset
- 17). Version number

## Playback interface instructions

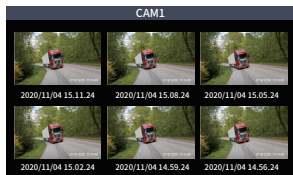

1. Press "MENU" to enter the playback interface.
2. Press "CH1" or "CH2" to select cam1/cam2/cam3/cam4 recording file in the playback list.
3. Press "CH3" or "CH4" to select previous file/next file in the playback list.
4. **2019/12/20 13:14:36** : REC real date and time.
5. **2019/12/20 13:14:48** : current recording file playback time display.

## 4. Accessories

| User manual*1PCS | Power cable*1PCS | Remote control*1PCS | Hexagon wrench*1PCS |
|------------------|------------------|---------------------|---------------------|
|                  |                  |                     |                     |

### Attention

To ensure our safety, the driver should not watch the video files or operate the monitor. The amateurish workers should not disassemble it without permission. If there are any product problems, please consult the local after-sales agency or take the defective product to the local maintenance department for repairing.

**Warning:** Please obey the local laws to install the product at a right position. Our company is not responsible for the law issue caused by the illegal installing.

**Attention:** When the weather is very cold. The LCD may be dark with power on. After the temperature will increase gradually, the LCD should be back to normal.

Don't press the LCD, which will cause the image distortion or faulty. please use soft wet cloth clean the LCD gently. Don't put this product into the wet environment or water, which will lead to short circuit, unnecessary loss or fire. please format SD card before insert it to the monitor. And put the SD card into the monitor under power off state. please stop recording or cut off the power before take out the SD card, in case there are any contents lost in the SD card.