

Introducing the CTEK I series

New generation industrial battery chargers



About CTEK

- ⚙️ The world's leading experts in battery care
- ⚙️ Two decades of dedication and innovation
- ⚙️ Regarded by vehicle manufacturers and workshop professionals as suppliers of good quality, premium products
- ⚙️ Suppliers to world recognised manufacturers
- ⚙️ High performance, reliable products, backed by a two-year warranty, outstanding customer service, training and technical support



Understanding the industrial workplace

- ⚙️ A tough environment - industrial vehicles work hard!
- ⚙️ Vehicle reliability is key
- ⚙️ Weight, space and environment are important considerations – smaller batteries need more regular charging
- ⚙️ Efficiency, safety and flexibility are paramount



Maximising industrial battery performance

- ⚙ Performance depends on vehicle activity, battery chemistry and charge frequency
- ⚙ A 24V battery in optimum condition increases vehicle reliability and reduces vehicle down time
- ⚙ Batteries not regularly charged to 100% capacity will cycle more often, have increased stratification and reduced capacity



The CTEK Iseries – for demanding industrial environments

Introducing the CTEK Iseries (I2420 and I2440)
24V battery chargers:

- ⚙️ Designed to meet the specific needs of the industrial sector with efficiency, flexibility and safety in mind
- ⚙️ Lightweight and compact, but robust
- ⚙️ Fully automatic
- ⚙️ Highly efficient for faster charging, enhanced productivity and reduced operating costs
- ⚙️ A unique combination of selectable charging programmes, advanced technology and SMART safety features



Features and benefits



Features and benefits



DURABLE

*INNOVATIVE
TECHNOLOGY*

*SELECTABLE
CHARGING
PROGRAMMES*

SAFE

*PUTS YOU
IN THE
PICTURE*

*CONNECT
AND FORGET*



Tough and robust

DURABLE

- ⚙️ Developed for use in even the harshest, hottest environments
- ⚙️ Robust black anodised aluminium design that is a completely sealed unit.
- ⚙️ Fitted with vibration absorbers to prevent unit damage
- ⚙️ IP64 rated (water and dust proof)
- ⚙️ High quality unit built for long life
- ⚙️ Two year warranty included



Transforming performance

INNOVATIVE
TECHNOLOGY

- ⚙️ Unique 'Resonant Converter' transformer technology
- ⚙️ Delivers high levels of current, with 94% efficiency for optimum charge levels in the shortest possible time
- ⚙️ Enables the charger to work in extreme temperatures of up to 40⁰ without de-rating (reducing) charge levels, and at even higher temperatures with reduced output current



Flexibility

SELECTABLE
CHARGING
PROGRAMMES

- ⚙ Room for 15 different charging programmes for different battery types, sizes and vehicle behaviours
- ⚙ Charges batteries from as low as 0.5V and automatically revives deeply discharged batteries
- ⚙ Suitable for all types of 24V battery including normal wet/flooded, Calcium (Ca/Ca) and Gel, AGM, EFB and also Lithium LIFePO4
- ⚙ If the battery needs to be swapped out for a different battery type, you don't need to swap out the charger – the charger can be re-programmed



User, vehicle and battery safety

- ⚙️ Advanced electronics – safe for permanent installation
- ⚙️ Drive-off protection so vehicle won't start if connected to the charger
- ⚙️ Reverse polarity and over voltage protection
- ⚙️ Built-in temperature sensor ensure the battery won't overheat, so it's completely safe for the battery, the vehicle and the user



Clear, simple display and analysis

PUTS YOU
IN THE
PICTURE

- ⚙️ LED lights show state of charge of the battery, so you know when it's time to charge
- ⚙️ A remote 2.5M or 5M LED wire is available as an accessory if the charger is mounted somewhere that is difficult to see or get to
- ⚙️ Logs the last 200 charge cycles including incomplete cycles, which can be downloaded by CTEK for analysis



Does the thinking for you

CONNECT
AND FORGET

- ⚙️ Connect it, forget it
- ⚙️ Can be left connected for unlimited periods of time
- ⚙️ No risk of damaging the battery
- ⚙️ Ensures the battery is never over or under charged



Technical specs



CTEK Iseries – product dimensions

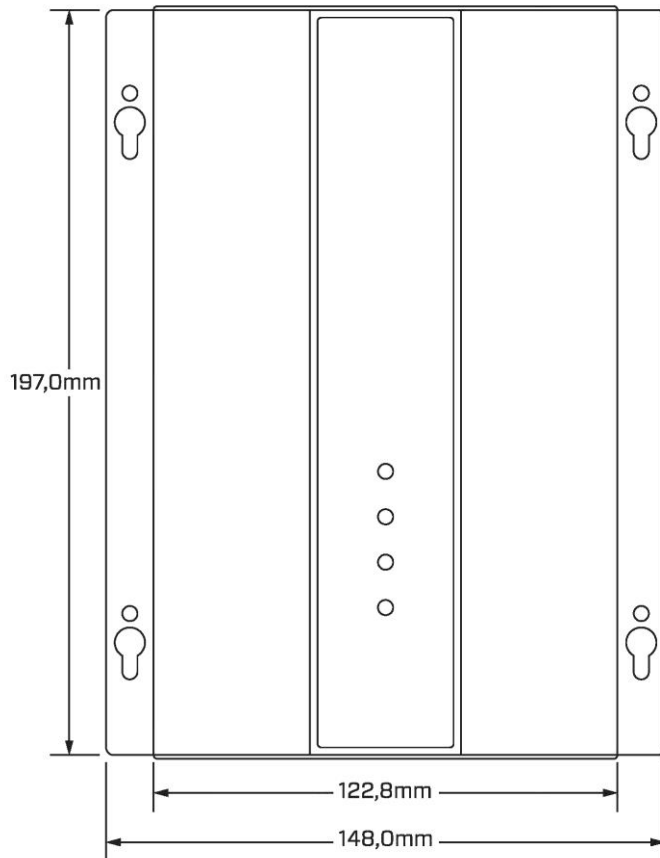

I2420 20A Icharger

- ⚙ Dimensions: 64mm high x 123mm (148mm) wide x 197mm long
- ⚙ Weight (excluding cables) 1.4 kg

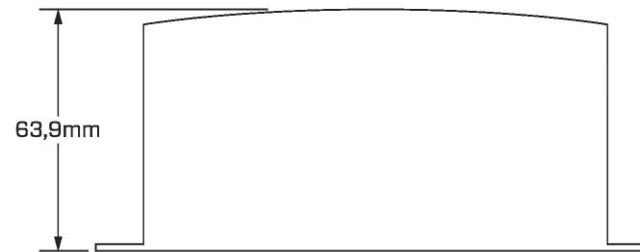

CTEK Iseries – product dimensions



I2440 40A Icharger

- ⚙ Dimensions: 80mm high x 204mm (234mm) wide x 286mm long
- ⚙ Weight (excluding cables) 3.0 kg

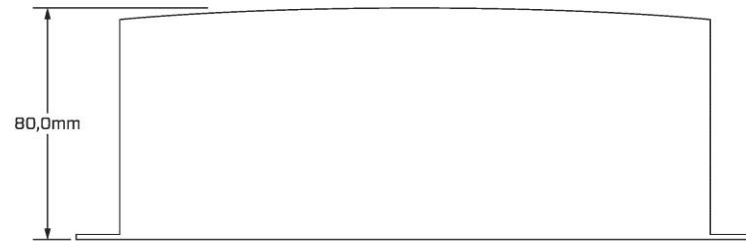

Technical spec

CTEK I2420 and I2440 Ichargers

- ⚙ Main 230V +10% / -15%
- ⚙ Power factor: ≈ 1
- ⚙ Conversion efficiency: Up to 94%
- ⚙ Standby power consumption: Max 0.5W
- ⚙ Protection class IP64
- ⚙ Output voltage: Up to 32V (nominal: 24V battery)
- ⚙ Output current: 20A for I2420, 40A for I2440
- ⚙ Output ripple: Max 100mVpp
- ⚙ Charging batteries from 0.5V (i.e. 42mVpc for a 24V battery)



Technical spec

CTEK I2420 and I2440 Ichargers

Certifications

- ⚙ IP64 rated (water and dust proof)
- ⚙ EMC & safety approved

Accessories

- ⚙ External multi collar LED wire indicating charging status as internal LED (available in 2.5m or 5m lengths)

